

M12 B-coding (Profibus)

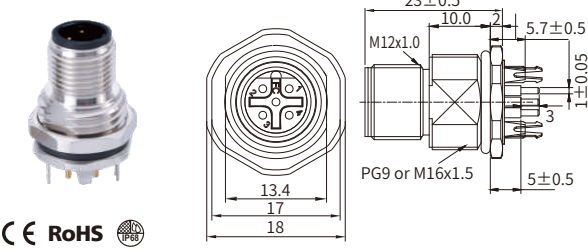

M12 B-coding Straight Connector, Panel Mount, PCB Type, Front fastened, shielded

Male



Female

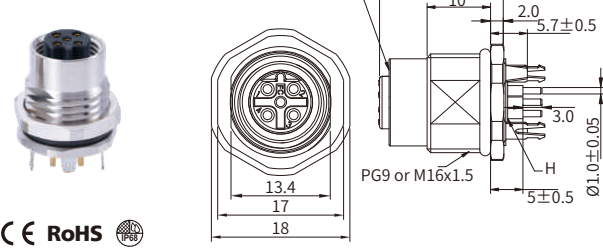

Specifications

Contacts	3	4	5
Certification	cULus CYJV2(CYJV8).E321413		cULus CYJV(CYJV7).E321413
Pin layout(Male)			
Pin layout(Female)			
Standard	IEC 61076-2-101		
Ambient temperature	-25°C ~ +90°C		
Connector insert	PA+GF		
Connector contacts	Brass with gold plated		
Coupling nut/screw	Brass with nickel plated		
Seal/O-ring	Epoxy resin / FKM		
Insulation resistance	≥100MΩ		
Contact resistance	≤5mΩ		
Earth tag/pin	Available		
IP rating	IP67, IP68 in locked condition		
Mating endurance	>500 cycles		
Rated current	4 A		
Rated voltage	250V AC/DC		60V AC/DC
Panel cut-out	Refer to page 384		
PCB layout	Refer to page 383		

Part Number

Pins	Male		Female	
	M16x1.5	PG9	M16x1.5	PG9
3	MB12MBS1BFF03ST-2	MB12MBS1BFF03ST-3	MB12FBS1BFF03ST-2	MB12FBS1BFF03ST-3
4	MB12MBS1BFF04ST-2	MB12MBS1BFF04ST-3	MB12FBS1BFF04ST-2	MB12FBS1BFF04ST-3
5	MB12MBS1BFF05ST-2	MB12MBS1BFF05ST-3	MB12FBS1BFF05ST-2	MB12FBS1BFF05ST-3